

# Glass Bottom Cell Culture Dishes & Plates & Cover Glasses

## Application

- Live cell observation
- Cell biology: cell research under STEM, cell cycle regulation, culture research
- Protein chemistry field: green fluorescent protein identification
- Molecular biology: genetic mapping and complex genetic researchResearch under dual and multiphoton confocal microscopy
- High quality imaging system
- Infrared imaging

## Main Customers

- Biological laboratory, research laboratory, laboratory professional customer needs, cell research laboratory, molecular laboratory, etc. Fluorescent, copolymerization, high-quality imaging microscope units with customer needs.



Cover Glass

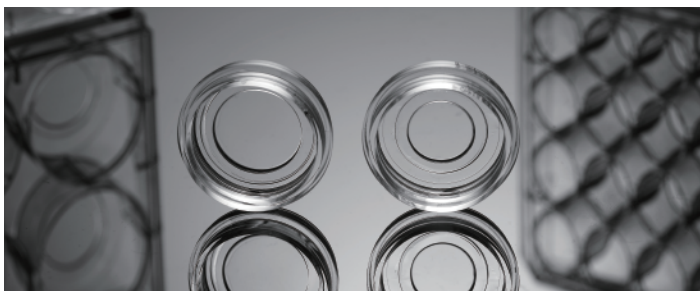

Glass Bottom Cell Culture Dish



Glass Bottom Culture Plate



## Cover Glasses

- High quality glass, non-cytotoxic.
- Sterile, non-treated.
- Manufactured in class 100,000 clean room.
- Resistant to organic solvent.
- Autoclavable.
- Suitable for used in confocal experiment.

### ● Tips:

Terilization: If the glass needs to be sterilized after a long period of non-use, it is recommended to wrap it in tin foil and sterilize it at 180°C in a metal container for two hours.

### ● Coating:

Coating can be done with polylysine, collagen, extracellular matrix, and some commercially available reagents containing layer adhesive protein, fibronectin, and proteoglycan, which can improve cell adhesion.

Glass Diameter (mm)	Application	/Pack	Cat.No.
14	24 Well Cell Culture Plate	100	801010
15	24 Well Cell Culture Plate	100	801007
18	12 Well Cell Culture Plate	100	801011
20	12 Well Cell Culture Plate	100	801008
25	6 Well Cell Culture Plate	100	801009

## Glass Bottom Cell Culture Dishes & Plates

- Can be used for live cell observation.
- Special bottom design for easy grip.
- Round cover glass inserts for good appearance.
- Medical adhesive glue to guarantee non-cytotoxicity.
- Sterilized by E-beam, SAL=10<sup>-6</sup>.
- Made of high clarity, 100% virgin polystyrene and high clarity glass as bottoms.
- High quality cover glass of standard thickness.

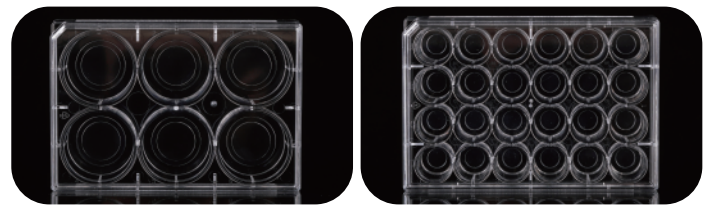

### ● Glass Bottom Culture Dish

Glass Diameter (mm)	Type (mm)	Cultivation Area (cm <sup>2</sup> )	Packaging	Cat.No.
15mm	28.2	6.2	10/pk, 200/cs	801002
20mm	28.2	6.2	10/pk, 200/cs	801001

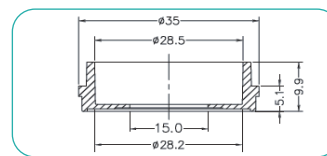

Ø15 Glass Bottom Dish

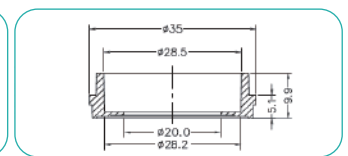

Ø20 Glass Bottom Dish

### ● Glass Bottom Culture Plate

Spec (Well)	Glass Diameter (mm)	Cultivation Area (cm <sup>2</sup> )	Packaging	Cat.No.
6	34.8	9.5	10/pk, 100/cs	801004
24	15.6	1.9	10/pk, 100/cs	801006

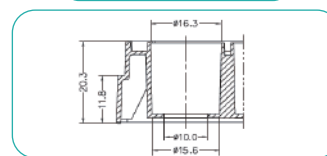

24 Well Glass Bottom Plate

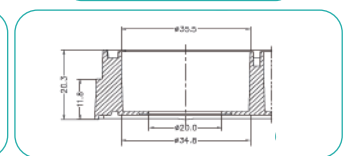

6 Well Glass Bottom Plate